

地番	開発面積			
測点名	X座標	Y座標	Y _{n+1} -Y _{n-1}	X _n (Y _{n+1} -Y _{n-1})
1	-206634.255	-65371.833	-1.790	369875.316450
2	-206632.704	-65372.731	-3.599	743671.101696
3	-206628.817	-65375.432	-3.335	689107.104695
4	-206629.285	-65376.066	-6.775	1399913.405875
Au53	-206622.085	-65382.207	-6.242	1289735.054570
5	-206621.966	-65382.308	-4.779	987446.375514
6	-206616.934	-65386.986	-8.750	1807898.172500
7	-206614.146	-65391.058	-5.694	1176460.947324
Au221	-206613.258	-65392.680	-5.020	1037198.555160
8	-206611.399	-65396.078	-9.673	1998552.062527
9	-206608.867	-65402.353	-10.491	2167533.623697
Au65	-206606.947	-65406.569	-8.347	1724548.186609
10	-206605.066	-65410.700	11.473	-2370379.922218
11	-206584.506	-65395.096	27.207	-5620544.654742
12	-206565.946	-65383.493	12.381	-2557492.977426
13	-206566.840	-65382.715	4.772	-985736.960480
14	-206572.133	-65378.721	5.018	-1036578.963394
15	-206573.490	-65377.697	1.869	-386085.852810
16	-206575.088	-65376.852	3.098	-639969.622624
17	-206580.325	-65374.599	3.048	-629656.830600
18	-206582.418	-65373.804	3.333	-688539.199194
19	-206583.896	-65371.266	5.916	-1222150.328736
20	-206588.874	-65367.888	5.613	-1159583.349762
Au200	-206592.616	-65365.653	6.266	-1294509.331856
Au201	-206591.299	-65361.622	3.663	-756743.928237
*1014	-206590.173	-65361.990	-4.316	891643.186668
*1012	-206574.338	-65365.938	-4.791	989697.653358
*1013	-206569.270	-65366.781	0.121	-24994.881670
Au244	-206568.970	-65365.817	1.927	-398058.405190
*1010	-206568.669	-65364.854	4.396	-908075.868924
Au50	-206564.866	-65361.421	5.878	-1214188.282348
1015	-206562.158	-65358.976	9.589	-1980724.533062
1016	-206555.547	-65351.832	13.656	-2820722.549832
36	-206559.517	-65345.320	8.064	-1665695.945088
35	-206561.532	-65343.768	5.583	-1153233.033156
34	-206568.501	-65339.737	4.105	-847963.696605
Au203	-206569.099	-65339.663	0.833	-172072.059467
33	-206575.246	-65338.904	5.327	-1100426.335442
Au230	-206582.100	-65334.336	7.342	-1516725.778200
32	-206586.262	-65331.562	8.313	-1717351.596006
31	-206594.531	-65326.023	5.774	-1192876.821994
56	-206594.883	-65325.788	0.296	-61152.085368
Au223	-206594.974	-65325.727	0.947	-195645.440378
*1001	-206596.301	-65324.841	-1.970	406994.712970
Au206	-206598.217	-65327.697	-4.517	933204.146189
*1002	-206599.343	-65329.358	-3.204	661944.294972
Au236	-206600.621	-65330.901	-3.046	629305.491566
*1003	-206601.865	-65332.404	-5.569	1150565.786185
*1004	-206605.667	-65336.470	-7.461	1541484.881487
Au39	-206609.228	-65339.865	-3.589	741520.519292
*1005	-206609.432	-65340.059	-3.597	743174.126904
*1006	-206613.112	-65343.462	-4.295	887403.316040
Au241	-206613.605	-65344.354	-1.784	368598.671320
23	-206614.098	-65345.246	-5.659	1169229.180582
Au51	-206617.869	-65350.013	-11.697	2416809.213693
24	-206623.352	-65356.943	-9.290	1919530.940080
Au60	-206625.219	-65359.303	-13.998	2892339.815562
25	-206634.427	-65370.941	-12.530	2589129.370310
倍面積				6635.978986
面積				3317.9894930
地積				3317.98 m ²

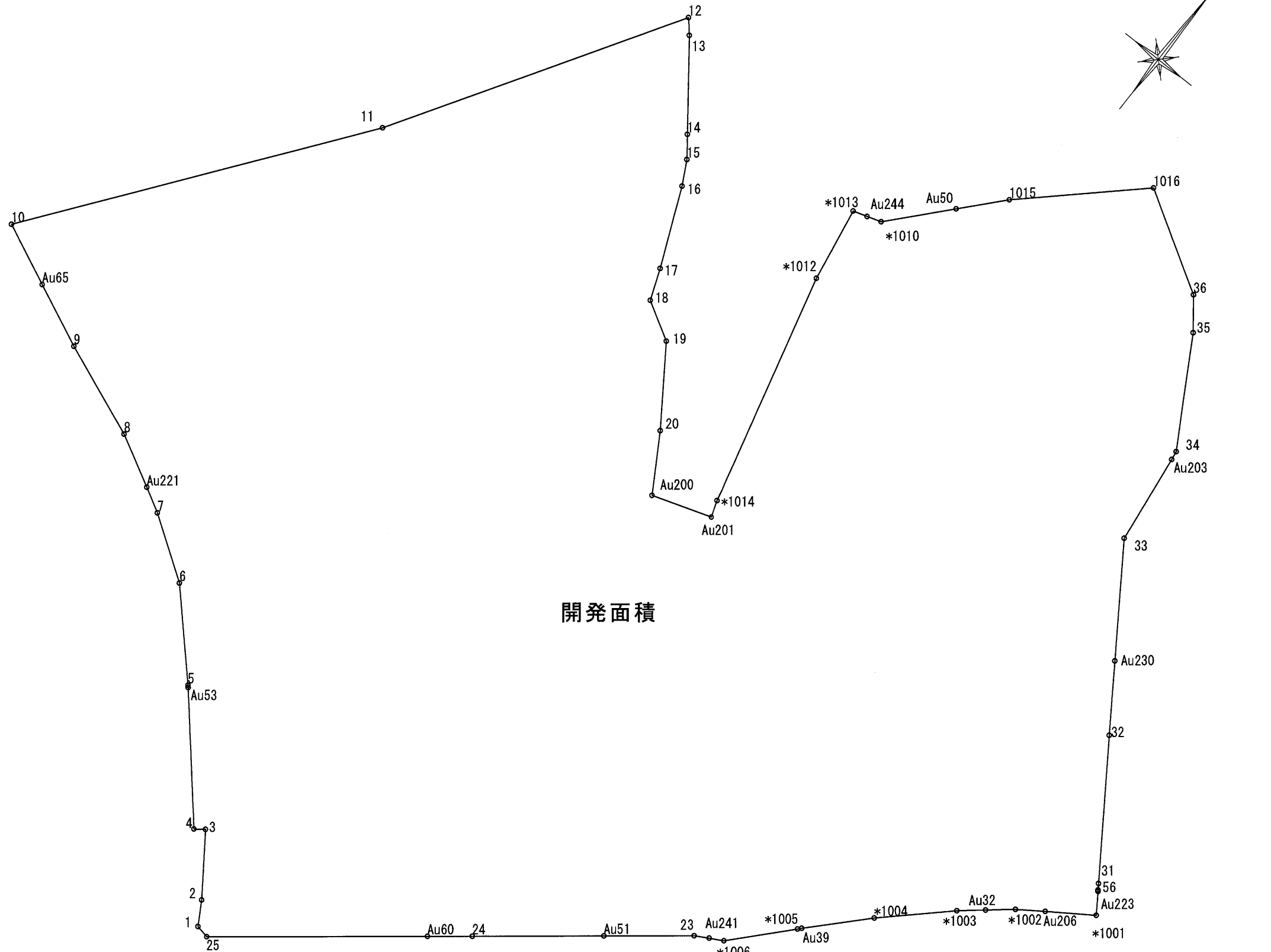

開発面積

開発面積 3317.98 m²

事業名	(仮称) 黒川字中山造成工事		
図面名称	求積図 1 / 4		
図面番号	4-1	縮尺	1:300
設計者	上坂章人	印	
株式会社クラスイー			

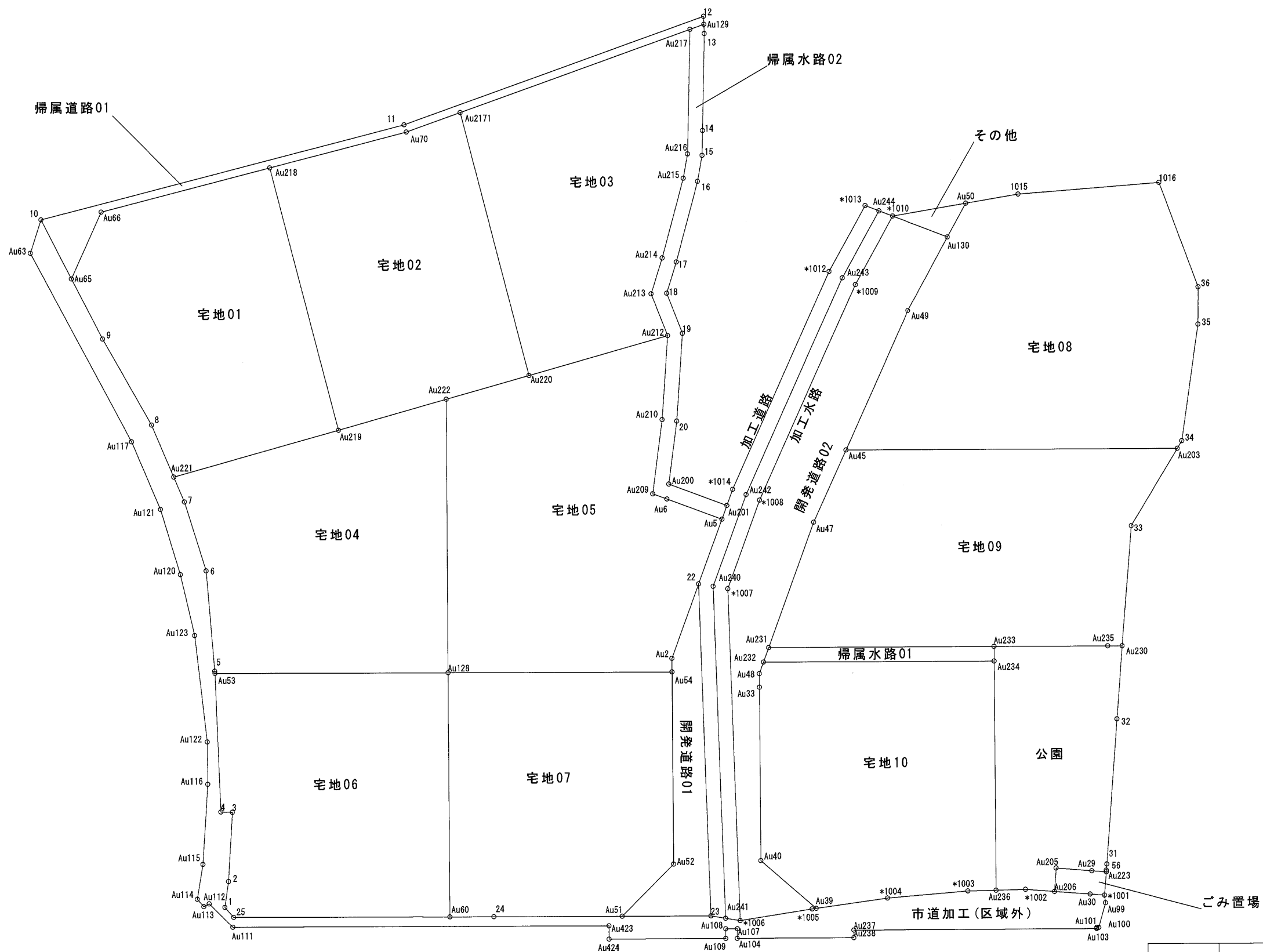
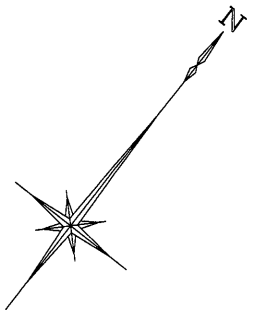

事業名	(仮称) 黒川字中山造成工事		
図面名称	求積図 2 / 4		
図面番号	4-2	縮尺	1:300
設計者	上坂章人	印	
株式会社クラスイー			

地番 宅地01				
測点名	X座標	Y座標	Y n+1-Y n-1	X n(Y n+1-Y n-1)
Au65	-206606.947	-65406.569	-5.439	1123735.184733
Au66	-206602.099	-65407.792	6.036	-1247050.269564
Au218	-206592.532	-65400.533	22.011	-4547308.221852
Au219	-206603.728	-65385.781	7.853	-1622459.075984
Au221	-206613.258	-65392.680	-10.297	2127496.717626
8	-206611.399	-65396.078	-9.673	1998552.062527
9	-206608.867	-65402.353	-10.491	2167533.623697
			倍面積	500.021183
			面積	250.0105915
			地積	250.01㎡

地番 宅地06				
測点名	X座標	Y座標	Y n+1-Y n-1	X n(Y n+1-Y n-1)
Au53	-206622.085	-65382.207	6.416	-1325687.297360
Au128	-206612.146	-65369.650	22.904	-4732244.591984
Au60	-206625.219	-65359.303	-1.291	266753.157729
25	-206634.427	-65370.941	-12.530	2589129.370310
1	-206634.255	-65371.833	-1.790	369875.316450
2	-206632.704	-65372.731	-3.599	743671.101696
3	-206628.817	-65375.432	-3.335	689107.104695
4	-206629.285	-65376.066	-6.775	1399913.405875
			倍面積	517.567411
			面積	258.7837055
			地積	258.78㎡

地番 開発道路01				
測点名	X座標	Y座標	Y n+1-Y n-1	X n(Y n+1-Y n-1)
22	-206596.734	-65359.845	-12.920	2669229.803280
Au2	-206601.870	-65358.166	2.257	-466300.420590
Au54	-206602.600	-65357.588	8.732	-1804053.903200
Au52	-206612.902	-65349.434	7.575	-1565092.732650
Au51	-206617.869	-65350.013	4.188	-865315.635372
23	-206614.098	-65345.246	-9.832	2031429.811536
			倍面積	-103.076996
			面積	51.5384980
			地積	51.53㎡

地番 帰属水路02				
測点名	X座標	Y座標	Y n+1-Y n-1	X n(Y n+1-Y n-1)
Au217	-206567.224	-65383.678	-4.592	948556.692608
Au129	-206566.356	-65383.136	0.963	-198923.400828
13	-206566.840	-65382.715	4.415	-911992.598600
14	-206572.133	-65378.721	5.018	-1036578.963394
15	-206573.490	-65377.697	1.869	-386085.852810
16	-206575.088	-65376.852	3.098	-639969.622624
17	-206580.325	-65374.599	3.048	-629656.830600
18	-206582.418	-65373.804	3.333	-688539.199194
19	-206583.896	-65371.266	5.916	-1222150.328736
20	-206588.874	-65367.888	5.613	-1159589.349762
Au200	-206592.616	-65365.653	6.266	-1294509.331856
Au201	-206591.299	-65361.622	4.342	-897019.420258
Au5	-206592.249	-65361.311	-3.506	724312.424994
Au6	-206593.497	-65365.128	-4.792	989996.037624
Au209	-206593.815	-65366.103	-3.604	744564.109260
Au210	-206589.412	-65368.732	-5.863	1211233.722556
Au212	-206584.646	-65371.966	-5.881	1214924.303126
Au213	-206583.104	-65374.613	-3.560	735435.850240
Au214	-206580.700	-65375.526	-3.142	649076.559400
Au215	-206575.520	-65377.755	-3.018	623444.919360
Au216	-206574.028	-65378.544	-5.923	1223537.967844
			倍面積	73.688350
			面積	36.8441750
			地積	36.84㎡

地番 宅地02				
測点名	X座標	Y座標	Y n+1-Y n-1	X n(Y n+1-Y n-1)
Au218	-206592.532	-65400.533	-8.887	1835987.831884
Au70	-206584.802	-65394.668	7.950	-1642349.175900
Au2171	-206581.467	-65392.583	16.876	-3486268.837092
Au220	-206592.693	-65377.792	11.325	-2339662.248225
Au222	-206597.480	-65381.258	-7.989	1650507.267720
Au219	-206603.728	-65385.781	-19.275	3982286.857200
			倍面積	501.695587
			面積	250.8477935
			地積	250.84㎡

地番 宅地07				
測点名	X座標	Y座標	Y n+1-Y n-1	X n(Y n+1-Y n-1)
Au128	-206612.146	-65369.650	1.715	-354339.830390
Au54	-206602.600	-65357.588	20.216	-4176678.161600
Au52	-206612.902	-65349.434	7.575	-1565092.732650
Au51	-206617.869	-65350.013	-7.509	1551493.578321
24	-206623.352	-65356.943	-9.290	1919530.940080
Au60	-206625.219	-65359.303	-12.707	2625586.657833
			倍面積	500.451594
			面積	250.2257970
			地積	250.22㎡

地番 開発道路02				
測点名	X座標	Y座標	Y n+1-Y n-1	X n(Y n+1-Y n-1)
*1010	-206568.669	-65364.854	2.989	-617433.751641
Au130	-206567.464	-65360.989	4.805	-992556.664520
Au49	-206573.116	-65360.049	3.464	-715569.273824
Au45	-206583.237	-65357.525	3.838	-792866.463606
Au47	-206588.510	-65356.211	4.738	-978816.360380
Au48	-206598.982	-65352.787	3.998	-825982.730036
Au33	-206599.707	-65352.213	7.928	-1637922.477096
Au40	-206608.998	-65344.859	12.348	-2551207.907304
Au39	-206609.228	-65339.865	4.800	-991724.294400
*1005	-206609.432	-65340.059	-3.597	743174.126904
*1006	-206613.112	-65343.462	-18.006	3720275.694672
*1007	-206595.744	-65358.065	-16.604	3430315.733376
*1008	-206589.619	-65360.066	-5.913	1221564.417147
*1009	-206573.931	-65363.978	-4.788	989075.981628
			倍面積	326.030920
			面積	163.0154600
			地積	163.01㎡

地番 宅地03				
測点名	X座標	Y座標	Y n+1-Y n-1	X n(Y n+1-Y n-1)
Au2171	-206581.467	-65392.583	-5.886	1215938.514762
Au217	-206567.224	-65383.678	14.039	-2899997.257736
Au216	-206574.028	-65378.544	5.923	-1223537.967844
Au215	-206575.520	-65377.755	3.018	-623444.919360
Au214	-206580.700	-65375.526	3.142	-649076.559400
Au213	-206583.104	-65374.613	3.560	-735435.850240
Au212	-206584.646	-65371.966	-3.179	656732.589634
Au220	-206592.693	-65377.792	-20.617	4259321.551581
			倍面積	500.101397
			面積	250.0506985
			地積	250.05㎡

地番 宅地08				
測点名	X座標	Y座標	Y n+1-Y n-1	X n(Y n+1-Y n-1)
Au50	-206564.866	-65361.421	2.013	-415815.075258
1015	-206562.158	-65358.976	9.589	-1980724.533062
1016	-206555.547	-65351.832	13.656	-2820722.549832
36	-206559.517	-65345.320	8.064	-1665695.945088
35	-206561.532	-65343.768	5.583	-1153233.033156
34	-206568.501	-65339.737	4.105	-847963.696605
Au203	-206569.099	-65339.663	-17.788	3674451.133012
Au45	-206583.237	-65357.525	-20.386	4211405.869482
Au49	-206573.116	-65360.049	-3.464	715569.273824
Au130	-206567.464	-65360.989	-1.372	283410.560608
			倍面積	682.003925
			面積	341.0019625
			地積	341.00㎡

地番 帰属道路01				
測点名	X座標	Y座標	Y n+1-Y n-1	X n(Y n+1-Y n-1)
10	-206605.066	-65410.700	11.473	-2370379.922218
11	-206584.506	-65395.096	27.207	-5620544.654742
12	-206565.946	-65383.493	11.960	-2470528.714160
Au129	-206566.356	-65383.136	-9.090	1877688.176040
Au2171	-206581.467	-65392.583	-11.532	2382297.477444
Au70	-206584.802	-65394.668	-7.950	1642349.175900
Au218	-206592.532	-65400.533	-13.124	2711320.389968
Au66	-206602.099	-65407.792	-6.036	1247050.269564
Au65	-206606.947	-65406.569	-2.908	600813.001876
			倍面積	65.199672
			面積	32.5998360
			地積	32.59㎡

地番 宅地04				
測点名	X座標	Y座標	Y n+1-Y n-1	X n(Y n+1-Y n-1)
Au221	-206613.258	-65392.680	5.277	-1090298.162466
Au219	-206603.728	-65385.781	11.422	-2359827.781216
Au222	-206597.480	-65381.258	16.131	-3332623.949880
Au128	-206612.146	-65369.650	-0.949	196074.926554
Au53	-206622.085	-65382.207	-12.658	2615422.351930
5	-206621.966	-65382.308	-4.779	987446.375514
6	-206616.934	-65386.986	-8.750	1807898.172500
7	-206614.146	-65391.058	-5.694	1176460.947324
			倍面積	552.880260
			面積	276.4401300
			地積	276.44㎡

地番 宅地09				
測点名	X座標	Y座標	Y n+1-Y n-1	X n(Y n+1-Y n-1)
Au45	-206583.237	-65357.525	16.548	-3418539.405876
Au203	-206569.099	-65339.663	18.621	-3846523.192479
33	-206575.246	-65338.904	5.327	-1100426.335442
Au230	-206582.100	-65334.336	3.781	-781086.920100
Au235	-206582.722	-65335.123	-6.901	1425627.364522
Au233	-206587.562	-65341.237	-18.256	3771462.531872
Au231	-206597.173	-65353.379	-14.974	3093586.068502
Au47	-206588.510	-65356.211	-4.146	856515.962460
			倍面積	616.073459
			面積	308.0367295
			地積	308.03㎡

地番 帰属水路01				
測点名	X座標	Y座標	Y n+1-Y n-1	X n(Y n+1-Y n-1)
Au231	-206597.173	-65353.379	11.811	-2440119.210303
Au233	-206587.562	-65341.237	12.763	-2636677.053806
Au234	-206588.346	-65340.616	-11.811	2440014.954606
Au232	-206598.185	-65353.048	-12.763	2636812.635155
			倍面積	31.325652
			面積	15.6628260
			地積	15.66㎡

地番 宅地05				
測点名	X座標	Y座標	Y n+1-Y n-1	X n(Y n+1-Y n-1)
Au222	-206597.480	-65381.258	-8.142	1682116.682160
Au220	-206592.693	-65377.792	9.292	-1919659.303356
Au212	-206584.646	-65371.966	9.060	-1871656.892760
Au210	-206589.412	-65368.732	5.863	-1211233.722556
Au209	-206593.815	-65366.103	3.604	-744564.109260
Au6	-206593.497	-65365.128	4.792	-989996.037624
Au5	-206592.249	-65361.311	5.283	-1091426.851467
22	-206596.734	-65359.845	3.145	-649746.728430
Au2	-206601.870	-65358.166	2.257	-466300.420590
Au54	-206602.600	-65357.588	-11.484	2372624.258400
Au128	-206612.146	-65369.650	-23.670	4890509.495820
			倍面積	666.370337
			面積	333.1851685
			地積	333.18㎡

地番 宅地10				
測点名	X座標	Y座標	Y n+1-Y n-1	X n(Y n+1-Y n-1)
Au48	-206598.982	-65352.787	-8.189	1691839.063598
Au232	-206598.185	-65353.048	12.171	-2514506.509635
Au234	-206588.346	-65340.616	22.147	-4575312.098862
Au236	-206600.621	-65330.901	8.212	-1696604.299652
*1003	-206601.865	-65332.404	-5.569	1150565.786185
*1004	-206605.667	-65336.470	-7.461	1541484.881487
Au39	-206609.228	-65339.865	-8.389	1733244.813692
Au4				

地番	加工道路				
測点名	X座標	Y座標	Y _{n+1} -Y _{n-1}	X _n (Y _{n+1} -Y _{n-1})	
*1013	-206569.270	-65366.781	0.121	-24994.881670	
Au244	-206568.970	-65365.817	1.823	-376575.232310	
Au243	-206574.134	-65364.958	4.788	-989076.953592	
Au242	-206589.892	-65361.029	6.003	-1240159.121676	
Au240	-206596.239	-65358.955	16.675	-3444992.285325	
Au241	-206613.605	-65344.354	13.709	-2832465.910945	
23	-206614.098	-65345.246	-15.491	3200658.992118	
22	-206596.734	-65359.845	-16.065	3318976.531710	
Au5	-206592.249	-65361.311	-1.777	367114.426473	
Au201	-206591.299	-65361.622	-0.679	140275.492021	
*1014	-206590.173	-65361.990	-4.316	891643.186668	
*1012	-206574.338	-65365.938	-4.791	989697.653358	
			倍面積	101.896830	
			面積	50.9484150	
			地積	50.94 m ²	

地番	加工水路				
測点名	X座標	Y座標	Y _{n+1} -Y _{n-1}	X _n (Y _{n+1} -Y _{n-1})	
Au244	-206568.970	-65365.817	0.104	-21483.172880	
*1010	-206568.669	-65364.854	1.839	-379879.782291	
*1009	-206573.931	-65363.978	4.788	-989075.981628	
*1008	-206589.619	-65360.066	5.913	-1221564.417147	
*1007	-206595.744	-65358.065	16.604	-3430315.733376	
*1006	-206613.112	-65343.462	13.711	-2832872.378632	
Au241	-206613.605	-65344.354	-15.493	3201064.582265	
Au240	-206596.239	-65358.955	-16.675	3444992.285325	
Au242	-206589.892	-65361.029	-6.003	1240159.121676	
Au243	-206574.134	-65364.958	-4.788	989076.953592	
			倍面積	101.476904	
			面積	50.7384520	
			地積	50.73 m ²	

地番	ごみ置場				
測点名	X座標	Y座標	Y _{n+1} -Y _{n-1}	X _n (Y _{n+1} -Y _{n-1})	
Au205	-206596.888	-65328.587	1.138	-235107.258544	
Au29	-206595.530	-65326.559	2.860	-590863.215800	
Au223	-206594.974	-65325.727	1.718	-354930.165332	
*1001	-206596.301	-65324.841	0.054	-11156.200254	
Au30	-206596.856	-65325.673	-2.856	590040.620736	
Au206	-206598.217	-65327.697	-2.914	602027.204338	
			倍面積	10.985144	
			面積	5.4925720	
			地積	5.49 m ²	

地番	その他				
測点名	X座標	Y座標	Y _{n+1} -Y _{n-1}	X _n (Y _{n+1} -Y _{n-1})	
*1010	-206568.669	-65364.854	-0.432	89237.665008	
Au50	-206564.866	-65361.421	3.865	-798373.207090	
Au130	-206567.464	-65360.989	-3.433	709146.103912	
			倍面積	10.561830	
			面積	5.2809150	
			地積	5.28 m ²	

地番	市道加工(区域外)				
測点名	X座標	Y座標	Y _{n+1} -Y _{n-1}	X _n (Y _{n+1} -Y _{n-1})	
10	-206605.066	-65410.700	3.288	-679317.457008	
Au65	-206606.947	-65406.569	8.347	-1724548.186609	
9	-206608.867	-65402.353	10.491	-2167533.623697	
8	-206611.399	-65396.078	9.673	-1998552.062527	
Au221	-206613.258	-65392.680	5.020	-1037198.555160	
7	-206614.146	-65391.058	5.694	-1176460.947324	
6	-206616.934	-65386.986	8.750	-1807898.172500	
5	-206621.966	-65382.308	4.779	-987446.375514	
Au53	-206622.085	-65382.207	6.242	-1289735.054570	
4	-206629.285	-65376.066	6.775	-1399913.405875	
3	-206628.817	-65375.432	3.335	-689107.104695	
2	-206632.704	-65372.731	3.599	-743671.101696	
1	-206634.255	-65371.833	1.790	-369875.316450	
25	-206634.427	-65370.941	12.530	-2589129.370310	
Au60	-206625.219	-65359.303	13.998	-2892339.815562	
24	-206623.352	-65356.943	9.290	-1919530.940080	
Au51	-206617.869	-65350.013	11.697	-2416809.213693	
23	-206614.098	-65345.246	6.551	-1353528.955998	
*1006	-206613.112	-65343.462	5.187	-1071702.211944	
*1005	-206609.432	-65340.059	3.597	-743174.126904	
Au39	-206609.228	-65339.865	3.589	-741520.519292	
*1004	-206605.667	-65336.470	7.461	-1541484.881487	
*1003	-206601.865	-65332.404	6.747	-1393942.783155	
Au32	-206599.645	-65329.723	3.046	-629302.518670	
*1002	-206599.343	-65329.358	2.026	-418570.268918	
Au206	-206598.217	-65327.697	4.517	-933204.146189	
*1001	-206596.301	-65324.841	3.228	-666892.859628	
Au99	-206596.669	-65324.469	1.038	-214447.342422	
Au100	-206598.297	-65323.803	0.558	-115281.849726	
Au101	-206598.379	-65323.911	-0.058	11982.705982	
Au103	-206598.442	-65323.861	-13.022	2690324.911724	
Au237	-206608.817	-65336.933	-12.746	2633435.981482	
Au238	-206609.228	-65336.607	-5.942	1227672.032776	
Au104	-206614.199	-65342.875	-6.675	1379149.778325	
Au107	-206613.677	-65343.282	-1.027	212192.246279	
Au108	-206614.176	-65343.902	-0.210	43388.976960	
Au109	-206614.694	-65343.492	-5.857	1210142.262758	
Au424	-206619.665	-65349.759	-6.836	1412452.029940	
Au423	-206618.948	-65350.328	-20.821	4302013.116308	
Au111	-206634.993	-65370.580	-22.508	4650940.422444	
Au112	-206634.732	-65372.836	-2.421	500262.686172	
Au113	-206635.113	-65373.001	-0.841	173780.130033	
Au114	-206634.992	-65373.677	-1.822	376488.955424	
Au115	-206632.882	-65374.823	-4.261	880462.710202	
Au116	-206628.359	-65377.938	-4.918	1016198.269562	
Au122	-206626.087	-65379.741	-6.945	1435018.174215	
Au123	-206620.903	-65384.883	-8.476	1751318.773828	
Au120	-206618.224	-65388.217	-7.163	1480006.338512	
Au121	-206615.565	-65392.046	-8.240	1702512.255600	
Au117	-206613.153	-65396.457	-17.811	3679986.868083	
Au63	-206607.317	-65409.857	-14.243	2942708.016031	
			倍面積	318.475037	
			面積	159.2375185	
			地積	159.23 m ²	

公共施設一覽

開発道路 316.21 m²

開発道路01	51.53 m ²
開発道路02	163.01 m ²
加工道路	50.94 m ²
加工水路	50.73 m ²

帰属道路 32.59 m²

帰属道路01	32.59 m ²
--------	----------------------

帰属水路 52.50 m²

帰属水路01	15.66 m ²
帰属水路02	36.84 m ²

公園 130.72 m²

公園	130.72 m ²
----	-----------------------

ごみ置場 5.49 m²

ごみ置場	5.49 m ²
------	---------------------

市道加工(区域外)

市道加工(区域外)	159.23 m ²
-----------	-----------------------

事業名	(仮称)黒川字中山造成工事		
図面名称	求積図4/4		
図面番号	4-4	縮尺	1:300
設計者	上坂章人	印	
株式会社クラスイー			